

Innovations Customized

MRS[®]
MODULAR
RACK SYSTEMS PVT LTD

**OUTDOOR
RACK SERIES**
**WALL / POLE / FLOOR
MOUNT RACKS**



Outdoor Wall / Pole / Floor Mount Racks

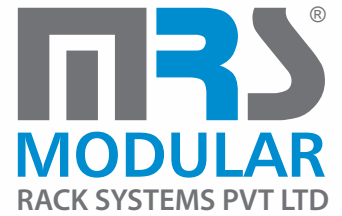

PRODUCT SUMMARY



CERTIFIED



MRS wall / pole / floor mount racks are designed for outdoor applications to meet IP55 applications. Racks are manufactured of pre galvanized iron (GI) steel sheets. Pre galvanized iron (GI) sheets are steel sheets that are coated with zinc and include a range of hot-dip galvanized and electro-galvanized steel sheets to protect the steel from the corrosive attack in most atmospheres, acting as a continuous and lasting shield between steel and the atmosphere. Due to this application, the lifetime of the product will be more. GI sheets punched, formed welded with a tight mechanical design, a clear line, and a vent system, outdoor satisfies the requirements of customers in both high-temperature locations and regions with extremely low temperatures. The rack frame perforation along with internal accessories creates a highly flexible cabinet. Using exhaust fans, cooling units, heat exchangers and heating will allow for a favorable climate and stable temperatures inside the cabinet.

- ◆ Designed directly for outdoor applications
- ◆ Simple, useful, functional construction
- ◆ The highest protection against corrosion
- ◆ Welded pre galvanized sheet steel.
- ◆ Perfect protection against weather
- ◆ Powder coat with UV protection
- ◆ Color RAL7035
- ◆ PU non-porous gasket – suitable for extreme temperature ranges
- ◆ IP55 dust and water protection
- ◆ Vandalism-proof – the side panels, rear panel, and roof are welded from inside, and they are equipped with closed hinges and compact metal handles
- ◆ Compact design - no point of access for lever-type tools

Available from 4U~15U, variants with 500mm depth.

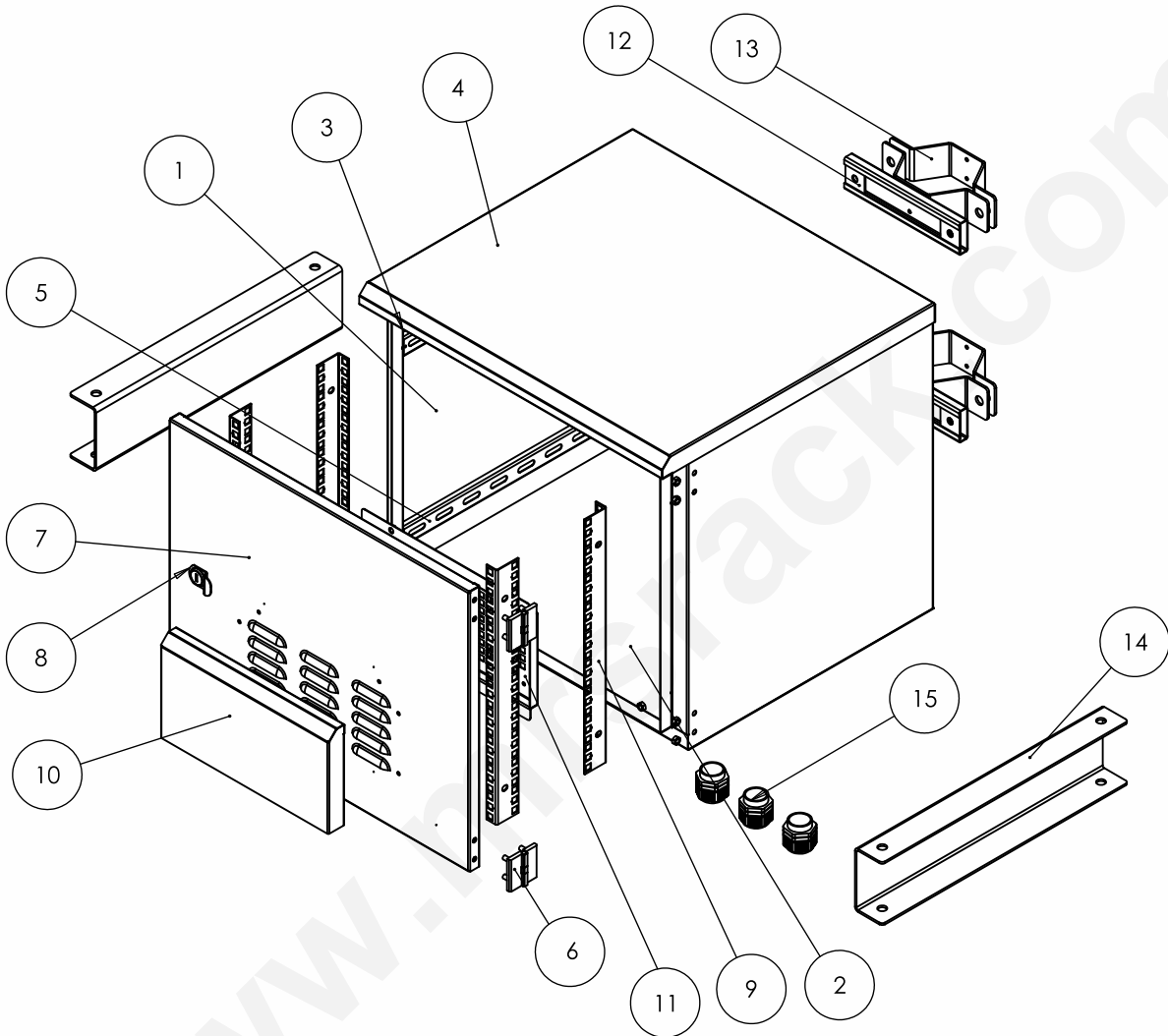

- | | | | | | |
|---|---------------|----|------------------|----|-------------------------|
| 1 | 500D Box | 6 | Hinges | 11 | Filter Tray |
| 2 | Bottom Panel | 7 | Front Door | 12 | Wall Mounting Brackets |
| 3 | Top Strip | 8 | CAM Lock | 13 | Pole Mounting Brackets |
| 4 | Canopy | 9 | 19" L Angle | 14 | Floor Mounting Brackets |
| 5 | Depth Members | 10 | Hood For Louvers | 15 | Cable Glands |

Product Features

- ◆ Conforms to DIN 41494 OR equivalent ISO Standards.
- ◆ Adjustable 19" equipment mounting angles with U marking provide the better mounting flexibility, maximize the usable mounting space.
- ◆ Depth adjustable mounting slots.
- ◆ Precision engineering capabilities and best efficient software configuration product technology provide the best product quality and fastest delivery in the industry.
- ◆ Top and bottom Panel with ventilation and cable entry facility.
- ◆ Provision to mount the cooling fans on the top/ Side panels or Front doors.
- ◆ Powder coated finish with Seven Tank pre- treatment process meeting all industrial standards
- ◆ Grounding and Bonding Options.
- ◆ 100% assured compatibility with all equipment conforming to DIN 41494. (General industrial standard for equipment)

▶ Technical Data

RACK STANDARD	Conforms to 41494 or equivalent standard
CONSTRUCTION	Welded
BASIC FRAME	Zinc Steel
FRONT DOOR	Lockable (Provided with Exhaust fan with canopy – Optional)
EQUIPMENT MOUNTING	DIN Standard 10mm. Square slots
19" MOUNTING ANGLE	Formed Steel Zinc
STANDARD FINISH	Powder Coating
STANDARD COLOR	Textured Grey / Black (Others on request)
TOP AND BOTTOM	Welded, with necessary ventilation and Cable entry cutouts on the bottom panel
STANDARD MOUNTING OPTION	Wall or Pole or Floor mounting brackets
STATIC LOAD	40 kgs

▶ Product Codes and Dimensions

PART CODE	Total Height in MM (H)	Usable Height in MM (H)	Total Width in MM (W)	Usable Width in Inches (W)	Total Depth in MM (D)	Usable Depth in MM (D)
MRS-ODWM-6050-04U	258	4U	600	19"	500	450
MRS-ODWM-6050-06U	347	6U	600	19"	500	450
MRS-ODWM-6050-09U	480	9U	600	19"	500	450
MRS-ODWM-6050-12U	613	12U	600	19"	500	450
MRS-ODWM-6050-15U	747	15U	600	19"	500	450

1U = 44.45 mm / 1.75 Inch

Note:

1. Other models can be manufactured on request.
2. It is recommended to distribute the load along with "U" space in the rack.
3. All dimensions are in mm.



MODULAR RACK SYSTEMS PVT. LTD.

No. 189 & 190, Nadikerappa Industrial Estate, Hegganahalli, Vishwaneedam Post, Bangalore-560 091 INDIA • Tel: +91 80 28365042 • Fax: +91 80 28367881
Mobile: +91 9108220086 • Email: admin@mrsrack.com



Innovations Customized

MRS[®]
MODULAR
RACK SYSTEMS PVT LTD

**OUTDOOR
RACK SERIES**
**WALL / POLE / FLOOR
MOUNT RACKS**





CERTIFIED



MRS wall / pole / floor mount racks are designed for outdoor applications to meet IP55 applications. Racks are manufactured of pre galvanized iron (GI) steel sheets. Pre galvanized iron (GI) sheets are steel sheets that are coated with zinc and include a range of hot-dip galvanized and electro-galvanized steel sheets to protect the steel from the corrosive attack in most atmospheres, acting as a continuous and lasting shield between steel and the atmosphere. Due to this application, the lifetime of the product will be more. GI sheets punched, formed welded with a tight mechanical design, a clear line, and a vent system, outdoor satisfies the requirements of customers in both high-temperature locations and regions with extremely low temperatures. The rack frame perforation along with internal accessories creates a highly flexible cabinet. Using exhaust fans, cooling units, heat exchangers and heating will allow for a favorable climate and stable temperatures inside the cabinet.

- ◆ Designed directly for outdoor applications
- ◆ Simple, useful, functional construction
- ◆ The highest protection against corrosion
- ◆ Welded pre galvanized sheet steel.
- ◆ Perfect protection against weather
- ◆ Powder coat with UV protection
- ◆ Color RAL7035
- ◆ PU non-porous gasket – suitable for extreme temperature ranges
- ◆ IP55 dust and water protection
- ◆ Vandalism-proof – the side panels, rear panel, and roof are welded from inside, and they are equipped with closed hinges and compact metal handles
- ◆ Compact design - no point of access for lever-type tools

Available from 4U~15U, variants with 500mm depth.

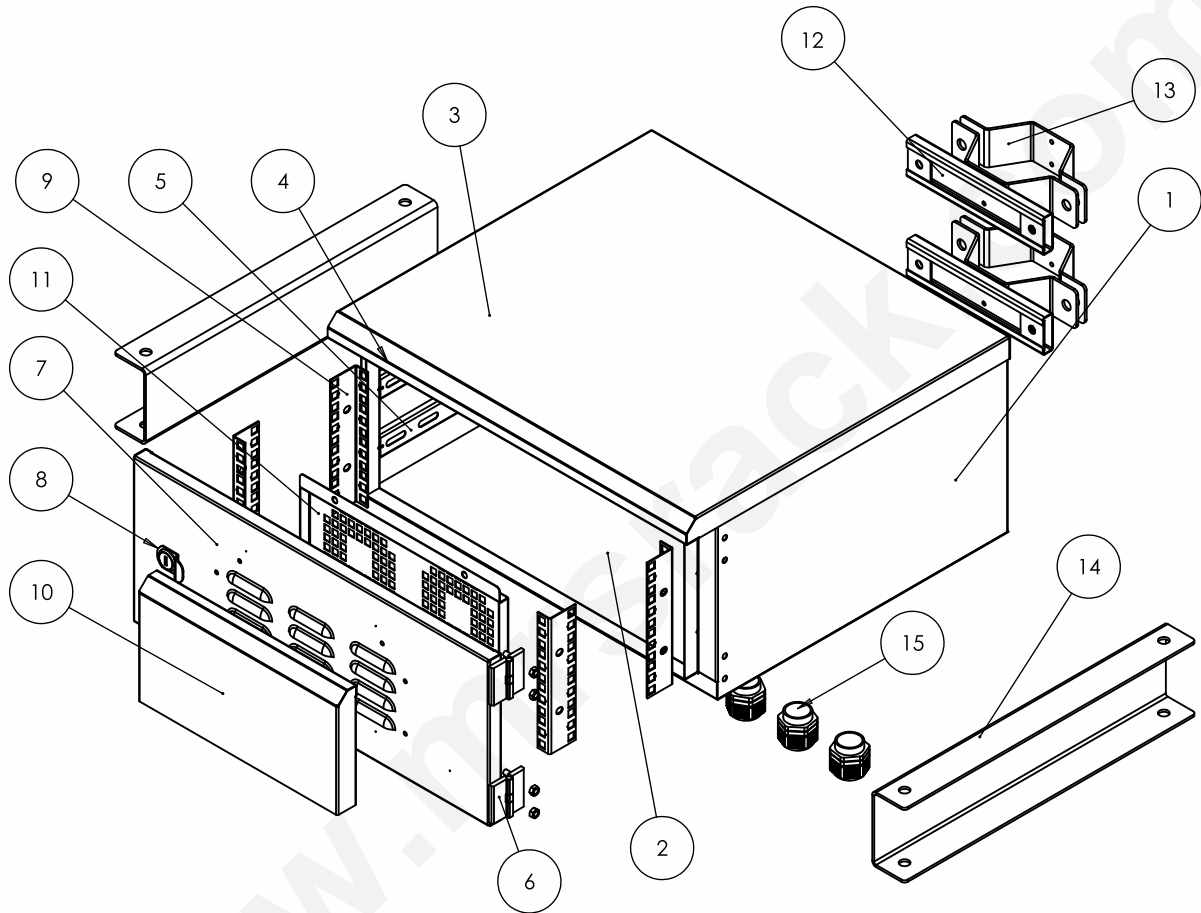

- | | | |
|-----------------|---------------------|----------------------------|
| 1 4U 500D Box | 6 Hinges | 11 Filter Tray |
| 2 Bottom Panel | 7 Front Door | 12 Wall Mounting Brackets |
| 3 Top Strip | 8 CAM Lock | 13 Pole Mounting Brackets |
| 4 Canopy | 9 19" L Angle | 14 Floor Mounting Brackets |
| 5 Depth Members | 10 Hood For Louvers | 15 Cable Glands |

Product Features

- ◆ Conforms to DIN 41494 OR equivalent ISO Standards.
- ◆ Adjustable 19" equipment mounting angles with U marking provide the better mounting flexibility, maximize the usable mounting space.
- ◆ Depth adjustable mounting slots.
- ◆ Precision engineering capabilities and best efficient software configuration product technology provide the best product quality and fastest delivery in the industry.
- ◆ Top and bottom Panel with ventilation and cable entry facility.
- ◆ Provision to mount the cooling fans on the top/ Side panels or Front doors.
- ◆ Powder coated finish with Seven Tank pre- treatment process meeting all industrial standards
- ◆ Grounding and Bonding Options.
- ◆ 100% assured compatibility with all equipment conforming to DIN 41494. (General industrial standard for equipment)

▶ Technical Data

RACK STANDARD	Conforms to 41494 or equivalent standard
CONSTRUCTION	Welded
BASIC FRAME	Zinc Steel
FRONT DOOR	Lockable (Provided with Exhaust fan with canopy – Optional)
EQUIPMENT MOUNTING	DIN Standard 10mm. Square slots
19" MOUNTING ANGLE	Formed Steel Zinc
STANDARD FINISH	Powder Coating
STANDARD COLOR	Textured Grey / Black (Others on request)
TOP AND BOTTOM	Welded, with necessary ventilation and Cable entry cutouts on the bottom panel
STANDARD MOUNTING OPTION	Wall or Pole or Floor mounting brackets
STATIC LOAD	40 kgs

▶ Product Codes and Dimensions

PART CODE	Total Height in MM (H)	Usable Height in MM (H)	Total Width in MM (W)	Usable Width in Inches (W)	Total Depth in MM (D)	Usable Depth in MM (D)
MRS-ODWM-6050-04U	258	4U	600	19"	500	450

1U = 44.45 mm / 1.75 Inch

Note:

1. Other models can be manufactured on request.
2. It is recommended to distribute the load along with "U" space in the rack.
3. All dimensions are in mm.



MODULAR RACK SYSTEMS PVT. LTD.

No. 189 & 190, Nadikerappa Industrial Estate, Hegganahalli, Vishwaneedam Post, Bangalore-560 091 INDIA • Tel: +91 80 28365042 • Fax: +91 80 28367881
Mobile: +91 9108220086 • Email: admin@mrsrack.com



Innovations Customized

MRS[®]
MODULAR
RACK SYSTEMS PVT LTD

**OUTDOOR
RACK SERIES**
**WALL / POLE / FLOOR
MOUNT RACKS**





MRS wall / pole / floor mount racks are designed for outdoor applications to meet IP55 applications. Racks are manufactured of pre galvanized iron (GI) steel sheets. Pre galvanized iron (GI) sheets are steel sheets that are coated with zinc and include a range of hot-dip galvanized and electro-galvanized steel sheets to protect the steel from the corrosive attack in most atmospheres, acting as a continuous and lasting shield between steel and the atmosphere. Due to this application, the lifetime of the product will be more. GI sheets punched, formed welded with a tight mechanical design, a clear line, and a vent system, outdoor satisfies the requirements of customers in both high-temperature locations and regions with extremely low temperatures. The rack frame perforation along with internal accessories creates a highly flexible cabinet. Using exhaust fans, cooling units, heat exchangers and heating will allow for a favorable climate and stable temperatures inside the cabinet.

- ◆ Designed directly for outdoor applications
- ◆ Simple, useful, functional construction
- ◆ The highest protection against corrosion
- ◆ Welded pre galvanized sheet steel.
- ◆ Perfect protection against weather
- ◆ Powder coat with UV protection
- ◆ Color RAL7035
- ◆ PU non-porous gasket – suitable for extreme temperature ranges
- ◆ IP55 dust and water protection
- ◆ Vandalism-proof – the side panels, rear panel, and roof are welded from inside, and they are equipped with closed hinges and compact metal handles
- ◆ Compact design - no point of access for lever-type tools

Available from 4U~15U, variants with 500mm depth.

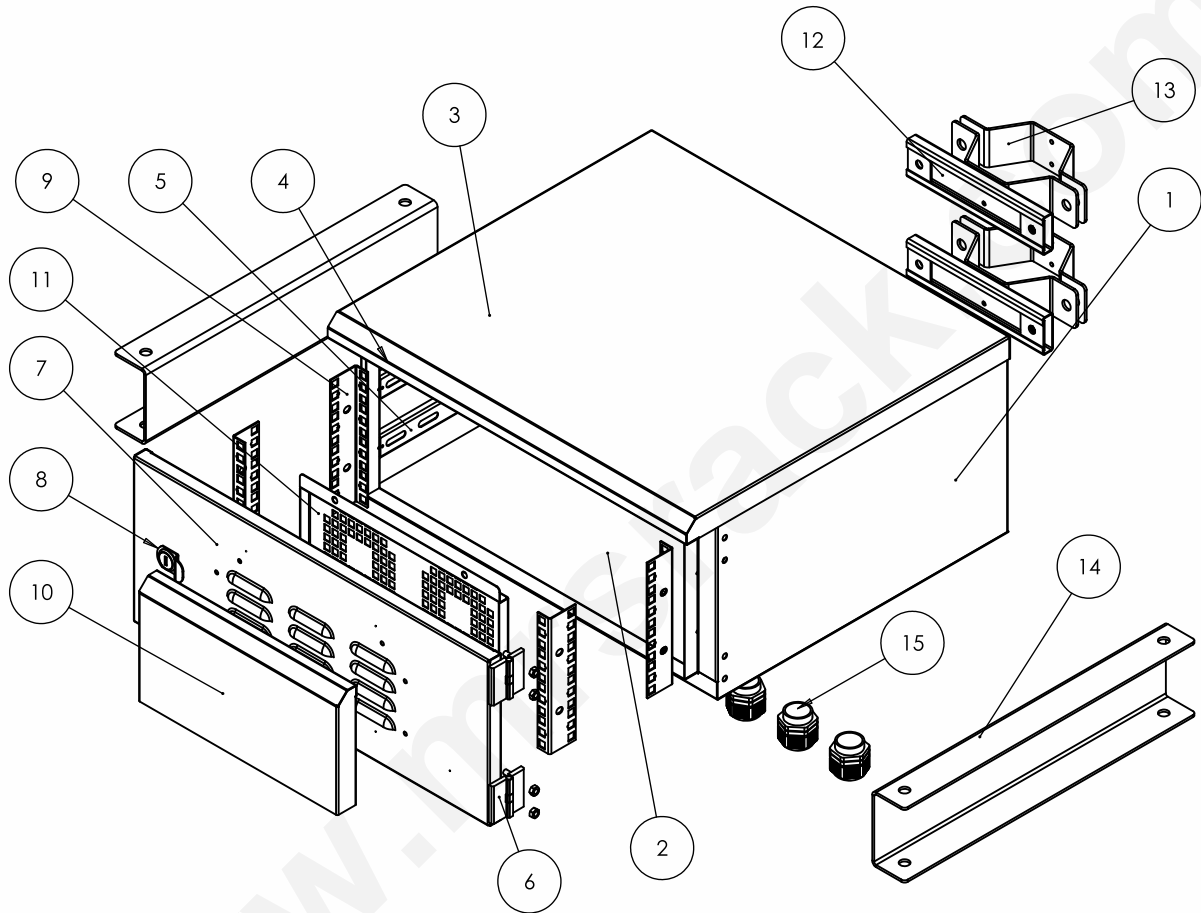

- | | | |
|-----------------|---------------------|----------------------------|
| 1 6U 500D Box | 6 Hinges | 11 Filter Tray |
| 2 Bottom Panel | 7 Front Door | 12 Wall Mounting Brackets |
| 3 Top Strip | 8 CAM Lock | 13 Pole Mounting Brackets |
| 4 Canopy | 9 19" L Angle | 14 Floor Mounting Brackets |
| 5 Depth Members | 10 Hood For Louvers | 15 Cable Glands |

Product Features

- ◆ Conforms to DIN 41494 OR equivalent ISO Standards.
- ◆ Adjustable 19" equipment mounting angles with U marking provide the better mounting flexibility, maximize the usable mounting space.
- ◆ Depth adjustable mounting slots.
- ◆ Precision engineering capabilities and best efficient software configuration product technology provide the best product quality and fastest delivery in the industry.
- ◆ Top and bottom Panel with ventilation and cable entry facility.
- ◆ Provision to mount the cooling fans on the top/ Side panels or Front doors.
- ◆ Powder coated finish with Seven Tank pre- treatment process meeting all industrial standards
- ◆ Grounding and Bonding Options.
- ◆ 100% assured compatibility with all equipment conforming to DIN 41494. (General industrial standard for equipment)

▶ Technical Data

RACK STANDARD	Conforms to 41494 or equivalent standard
CONSTRUCTION	Welded
BASIC FRAME	Zinc Steel
FRONT DOOR	Lockable (Provided with Exhaust fan with canopy – Optional)
EQUIPMENT MOUNTING	DIN Standard 10mm. Square slots
19" MOUNTING ANGLE	Formed Steel Zinc
STANDARD FINISH	Powder Coating
STANDARD COLOR	Textured Grey / Black (Others on request)
TOP AND BOTTOM	Welded, with necessary ventilation and Cable entry cutouts on the bottom panel
STANDARD MOUNTING OPTION	Wall or Pole or Floor mounting brackets
STATIC LOAD	40 kgs

▶ Product Codes and Dimensions

PART CODE	Total Height in MM (H)	Usable Height in MM (H)	Total Width in MM (W)	Usable Width in Inches (W)	Total Depth in MM (D)	Usable Depth in MM (D)
MRS-ODWM-6050-06U	347	6U	600	19"	500	450

1U = 44.45 mm / 1.75 Inch

Note:

1. Other models can be manufactured on request.
2. It is recommended to distribute the load along with "U" space in the rack.
3. All dimensions are in mm.



MODULAR RACK SYSTEMS PVT. LTD.

No. 189 & 190, Nadikerappa Industrial Estate, Hegganahalli, Vishwaneedam Post, Bangalore-560 091 INDIA • Tel: +91 80 28365042 • Fax: +91 80 28367881
Mobile: +91 9108220086 • Email: admin@mrsrack.com



Innovations Customized

MRS[®]
MODULAR
RACK SYSTEMS PVT LTD

**OUTDOOR
RACK SERIES**
**WALL / POLE / FLOOR
MOUNT RACKS**





CERTIFIED



MRS wall / pole / floor mount racks are designed for outdoor applications to meet IP55 applications. Racks are manufactured of pre galvanized iron (GI) steel sheets. Pre galvanized iron (GI) sheets are steel sheets that are coated with zinc and include a range of hot-dip galvanized and electro-galvanized steel sheets to protect the steel from the corrosive attack in most atmospheres, acting as a continuous and lasting shield between steel and the atmosphere. Due to this application, the lifetime of the product will be more. GI sheets punched, formed welded with a tight mechanical design, a clear line, and a vent system, outdoor satisfies the requirements of customers in both high-temperature locations and regions with extremely low temperatures. The rack frame perforation along with internal accessories creates a highly flexible cabinet. Using exhaust fans, cooling units, heat exchangers and heating will allow for a favorable climate and stable temperatures inside the cabinet.

- ◆ Designed directly for outdoor applications
- ◆ Simple, useful, functional construction
- ◆ The highest protection against corrosion
- ◆ Welded pre galvanized sheet steel.
- ◆ Perfect protection against weather
- ◆ Powder coat with UV protection
- ◆ Color RAL7035
- ◆ PU non-porous gasket – suitable for extreme temperature ranges
- ◆ IP55 dust and water protection
- ◆ Vandalism-proof – the side panels, rear panel, and roof are welded from inside, and they are equipped with closed hinges and compact metal handles
- ◆ Compact design - no point of access for lever-type tools

Available from 4U~15U, variants with 500mm depth.

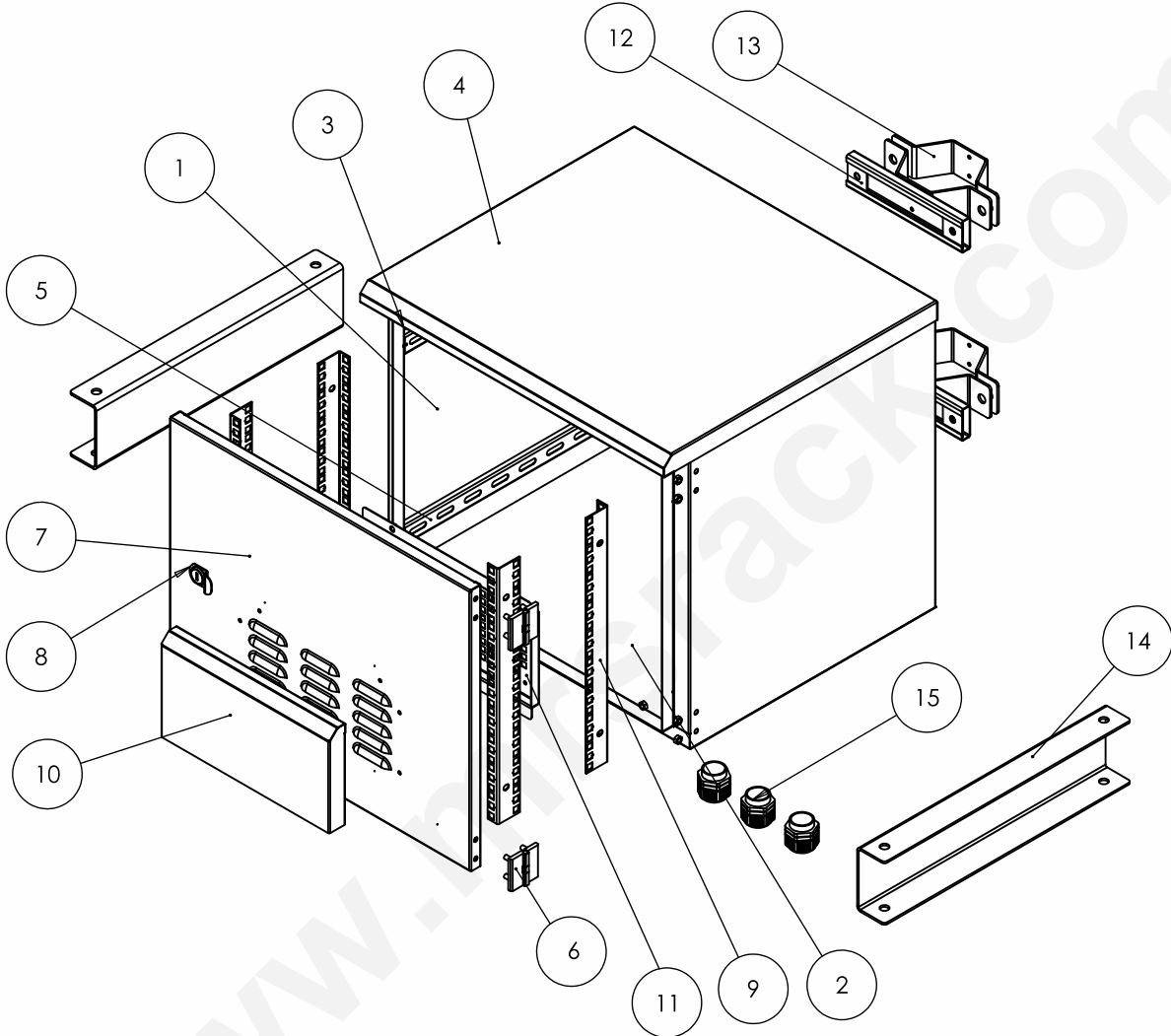

- | | | | | | |
|---|---------------|----|------------------|----|-------------------------|
| 1 | 9U 500D Box | 6 | Hinges | 11 | Filter Tray |
| 2 | Bottom Panel | 7 | Front Door | 12 | Wall Mounting Brackets |
| 3 | Top Strip | 8 | CAM Lock | 13 | Pole Mounting Brackets |
| 4 | Canopy | 9 | 19" L Angle | 14 | Floor Mounting Brackets |
| 5 | Depth Members | 10 | Hood For Louvers | 15 | Cable Glands |

Product Features

- ◆ Conforms to DIN 41494 OR equivalent ISO Standards.
- ◆ Adjustable 19" equipment mounting angles with U marking provide the better mounting flexibility, maximize the usable mounting space.
- ◆ Depth adjustable mounting slots.
- ◆ Precision engineering capabilities and best efficient software configuration product technology provide the best product quality and fastest delivery in the industry.
- ◆ Top and bottom Panel with ventilation and cable entry facility.
- ◆ Provision to mount the cooling fans on the top/ Side panels or Front doors.
- ◆ Powder coated finish with Seven Tank pre- treatment process meeting all industrial standards
- ◆ Grounding and Bonding Options.
- ◆ 100% assured compatibility with all equipment conforming to DIN 41494. (General industrial standard for equipment)

▶ Technical Data

RACK STANDARD	Conforms to 41494 or equivalent standard
CONSTRUCTION	Welded
BASIC FRAME	Zinc Steel
FRONT DOOR	Lockable (Provided with Exhaust fan with canopy – Optional)
EQUIPMENT MOUNTING	DIN Standard 10mm. Square slots
19" MOUNTING ANGLE	Formed Steel Zinc
STANDARD FINISH	Powder Coating
STANDARD COLOR	Textured Grey / Black (Others on request)
TOP AND BOTTOM	Welded, with necessary ventilation and Cable entry cutouts on the bottom panel
STANDARD MOUNTING OPTION	Wall or Pole or Floor mounting brackets
STATIC LOAD	40 kgs

▶ Product Codes and Dimensions

PART CODE	Total Height in MM (H)	Usable Height in MM (H)	Total Width in MM (W)	Usable Width in Inches (W)	Total Depth in MM (D)	Usable Depth in MM (D)
MRS-ODWM-6050-09U	480	9U	600	19"	500	450

1U = 44.45 mm / 1.75 Inch

Note:

1. Other models can be manufactured on request.
2. It is recommended to distribute the load along with "U" space in the rack.
3. All dimensions are in mm.



MODULAR RACK SYSTEMS PVT. LTD.

No. 189 & 190, Nadikerappa Industrial Estate, Hegganahalli, Vishwaneedam Post, Bangalore-560 091 INDIA • Tel: +91 80 28365042 • Fax: +91 80 28367881
Mobile: +91 9108220086 • Email: admin@mrsrack.com



Innovations Customized

MRS[®]
MODULAR
RACK SYSTEMS PVT LTD

**OUTDOOR
RACK SERIES**
**WALL / POLE / FLOOR
MOUNT RACKS**





CERTIFIED



MRS wall / pole / floor mount racks are designed for outdoor applications to meet IP55 applications. Racks are manufactured of pre galvanized iron (GI) steel sheets. Pre galvanized iron (GI) sheets are steel sheets that are coated with zinc and include a range of hot-dip galvanized and electro-galvanized steel sheets to protect the steel from the corrosive attack in most atmospheres, acting as a continuous and lasting shield between steel and the atmosphere. Due to this application, the lifetime of the product will be more. GI sheets punched, formed welded with a tight mechanical design, a clear line, and a vent system, outdoor satisfies the requirements of customers in both high-temperature locations and regions with extremely low temperatures. The rack frame perforation along with internal accessories creates a highly flexible cabinet. Using exhaust fans, cooling units, heat exchangers and heating will allow for a favorable climate and stable temperatures inside the cabinet.

- ◆ Designed directly for outdoor applications
- ◆ Simple, useful, functional construction
- ◆ The highest protection against corrosion
- ◆ Welded pre galvanized sheet steel.
- ◆ Perfect protection against weather
- ◆ Powder coat with UV protection
- ◆ Color RAL7035
- ◆ PU non-porous gasket – suitable for extreme temperature ranges
- ◆ IP55 dust and water protection
- ◆ Vandalism-proof – the side panels, rear panel, and roof are welded from inside, and they are equipped with closed hinges and compact metal handles
- ◆ Compact design - no point of access for lever-type tools

Available from 4U~15U, variants with 500mm depth.

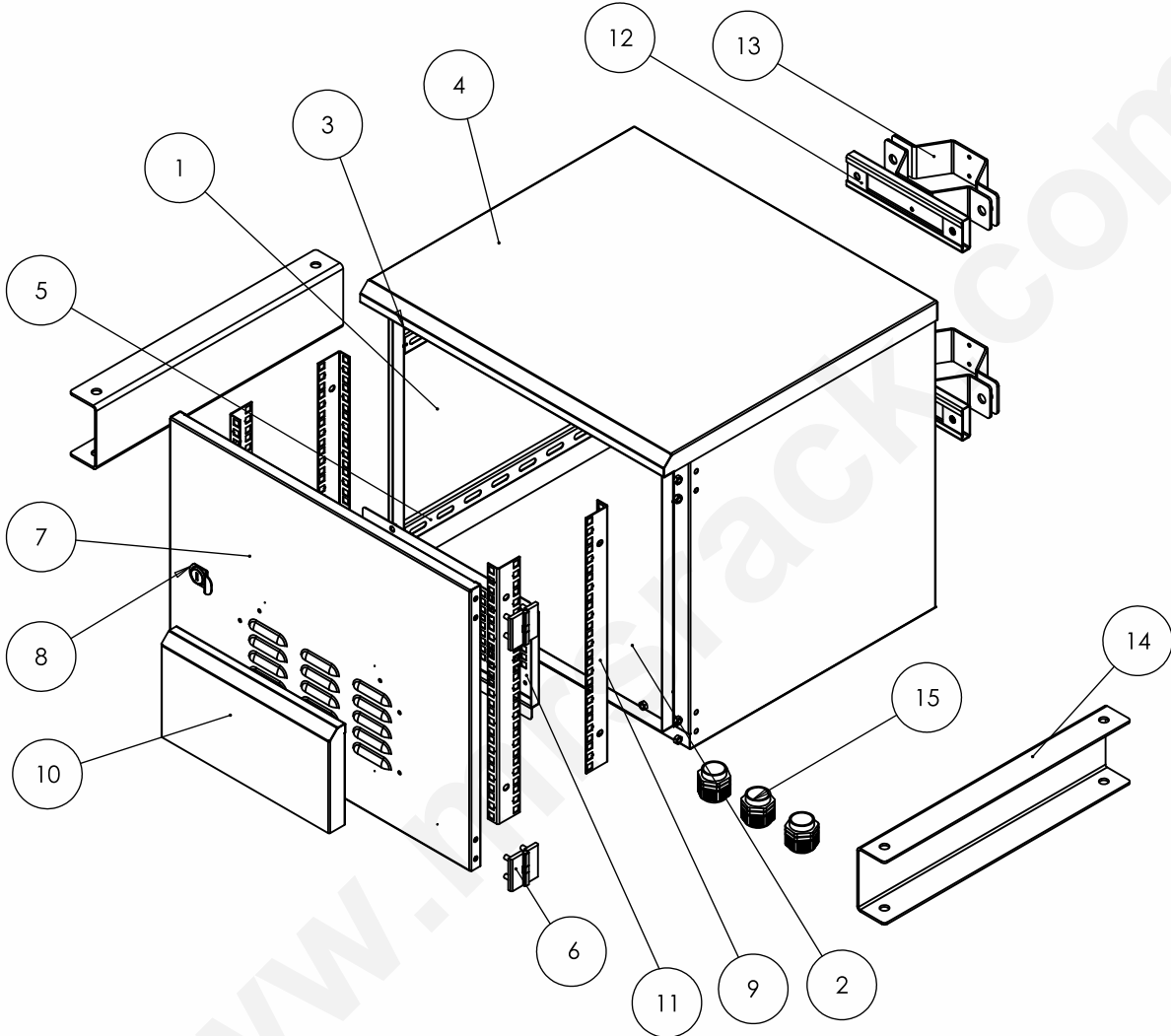

- | | | | | | |
|---|---------------|----|------------------|----|-------------------------|
| 1 | 12U 500D Box | 6 | Hinges | 11 | Filter Tray |
| 2 | Bottom Panel | 7 | Front Door | 12 | Wall Mounting Brackets |
| 3 | Top Strip | 8 | CAM Lock | 13 | Pole Mounting Brackets |
| 4 | Canopy | 9 | 19" L Angle | 14 | Floor Mounting Brackets |
| 5 | Depth Members | 10 | Hood For Louvers | 15 | Cable Glands |

Product Features

- ◆ Conforms to DIN 41494 OR equivalent ISO Standards.
- ◆ Adjustable 19" equipment mounting angles with U marking provide the better mounting flexibility, maximize the usable mounting space.
- ◆ Depth adjustable mounting slots.
- ◆ Precision engineering capabilities and best efficient software configuration product technology provide the best product quality and fastest delivery in the industry.
- ◆ Top and bottom Panel with ventilation and cable entry facility.
- ◆ Provision to mount the cooling fans on the top/ Side panels or Front doors.
- ◆ Powder coated finish with Seven Tank pre- treatment process meeting all industrial standards
- ◆ Grounding and Bonding Options.
- ◆ 100% assured compatibility with all equipment conforming to DIN 41494. (General industrial standard for equipment)

▶ Technical Data

RACK STANDARD	Conforms to 41494 or equivalent standard
CONSTRUCTION	Welded
BASIC FRAME	Zinc Steel
FRONT DOOR	Lockable (Provided with Exhaust fan with canopy – Optional)
EQUIPMENT MOUNTING	DIN Standard 10mm. Square slots
19" MOUNTING ANGLE	Formed Steel Zinc
STANDARD FINISH	Powder Coating
STANDARD COLOR	Textured Grey / Black (Others on request)
TOP AND BOTTOM	Welded, with necessary ventilation and Cable entry cutouts on the bottom panel
STANDARD MOUNTING OPTION	Wall or Pole or Floor mounting brackets
STATIC LOAD	40 kgs

▶ Product Codes and Dimensions

PART CODE	Total Height in MM (H)	Usable Height in MM (H)	Total Width in MM (W)	Usable Width in Inches (W)	Total Depth in MM (D)	Usable Depth in MM (D)
MRS-ODWM-6050-12U	613	12U	600	19"	500	450

1U = 44.45 mm / 1.75 Inch

Note:

1. Other models can be manufactured on request.
2. It is recommended to distribute the load along with "U" space in the rack.
3. All dimensions are in mm.



MODULAR RACK SYSTEMS PVT. LTD.

No. 189 & 190, Nadikerappa Industrial Estate, Hegganahalli, Vishwaneedam Post, Bangalore-560 091 INDIA • Tel: +91 80 28365042 • Fax: +91 80 28367881
Mobile: +91 9108220086 • Email: admin@mrsrack.com



Innovations Customized

MRS[®]
MODULAR
RACK SYSTEMS PVT LTD

**OUTDOOR
RACK SERIES**
**WALL / POLE / FLOOR
MOUNT RACKS**





CERTIFIED



MRS wall / pole / floor mount racks are designed for outdoor applications to meet IP55 applications. Racks are manufactured of pre galvanized iron (GI) steel sheets. Pre galvanized iron (GI) sheets are steel sheets that are coated with zinc and include a range of hot-dip galvanized and electro-galvanized steel sheets to protect the steel from the corrosive attack in most atmospheres, acting as a continuous and lasting shield between steel and the atmosphere. Due to this application, the lifetime of the product will be more. GI sheets punched, formed welded with a tight mechanical design, a clear line, and a vent system, outdoor satisfies the requirements of customers in both high-temperature locations and regions with extremely low temperatures. The rack frame perforation along with internal accessories creates a highly flexible cabinet. Using exhaust fans, cooling units, heat exchangers and heating will allow for a favorable climate and stable temperatures inside the cabinet.

- ◆ Designed directly for outdoor applications
- ◆ Simple, useful, functional construction
- ◆ The highest protection against corrosion
- ◆ Welded pre galvanized sheet steel.
- ◆ Perfect protection against weather
- ◆ Powder coat with UV protection
- ◆ Color RAL7035
- ◆ PU non-porous gasket – suitable for extreme temperature ranges
- ◆ IP55 dust and water protection
- ◆ Vandalism-proof – the side panels, rear panel, and roof are welded from inside, and they are equipped with closed hinges and compact metal handles
- ◆ Compact design - no point of access for lever-type tools

Available from 4U~15U, variants with 500mm depth.

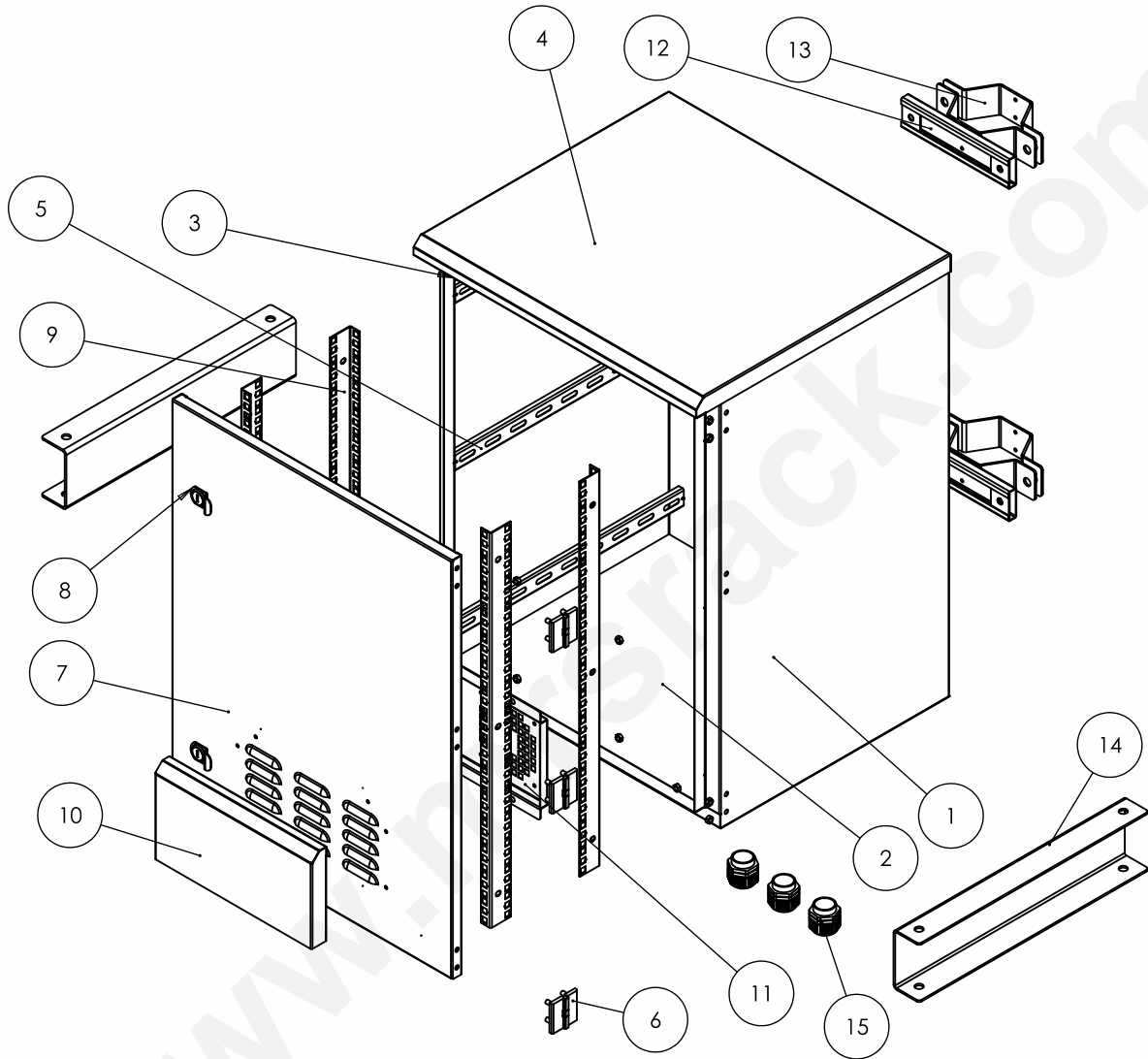

- | | | |
|-----------------|---------------------|----------------------------|
| 1 15U 500D Box | 6 Hinges | 11 Filter Tray |
| 2 Bottom Panel | 7 Front Door | 12 Wall Mounting Brackets |
| 3 Top Strip | 8 CAM Lock | 13 Pole Mounting Brackets |
| 4 Canopy | 9 19" L Angle | 14 Floor Mounting Brackets |
| 5 Depth Members | 10 Hood For Louvers | 15 Cable Glands |

Product Features

- ◆ Conforms to DIN 41494 OR equivalent ISO Standards.
- ◆ Adjustable 19" equipment mounting angles with U marking provide the better mounting flexibility, maximize the usable mounting space.
- ◆ Depth adjustable mounting slots.
- ◆ Precision engineering capabilities and best efficient software configuration product technology provide the best product quality and fastest delivery in the industry.
- ◆ Top and bottom Panel with ventilation and cable entry facility.
- ◆ Provision to mount the cooling fans on the top/ Side panels or Front doors.
- ◆ Powder coated finish with Seven Tank pre- treatment process meeting all industrial standards
- ◆ Grounding and Bonding Options.
- ◆ 100% assured compatibility with all equipment conforming to DIN 41494. (General industrial standard for equipment)

▶ Technical Data

RACK STANDARD	Conforms to 41494 or equivalent standard
CONSTRUCTION	Welded
BASIC FRAME	Zinc Steel
FRONT DOOR	Lockable (Provided with Exhaust fan with canopy – Optional)
EQUIPMENT MOUNTING	DIN Standard 10mm. Square slots
19" MOUNTING ANGLE	Formed Steel Zinc
STANDARD FINISH	Powder Coating
STANDARD COLOR	Textured Grey / Black (Others on request)
TOP AND BOTTOM	Welded, with necessary ventilation and Cable entry cutouts on the bottom panel
STANDARD MOUNTING OPTION	Wall or Pole or Floor mounting brackets
STATIC LOAD	40 kgs

▶ Product Codes and Dimensions

PART CODE	Total Height in MM (H)	Usable Height in MM (H)	Total Width in MM (W)	Usable Width in Inches (W)	Total Depth in MM (D)	Usable Depth in MM (D)
MRS-ODWM-6050-15U	747	15U	600	19"	500	450

1U = 44.45 mm / 1.75 Inch

Note:

1. Other models can be manufactured on request.
2. It is recommended to distribute the load along with "U" space in the rack.
3. All dimensions are in mm.



MODULAR RACK SYSTEMS PVT. LTD.

No. 189 & 190, Nadikerappa Industrial Estate, Hegganahalli, Vishwanedam Post, Bangalore-560 091 INDIA • Tel: +91 80 28365042 • Fax: +91 80 28367881
Mobile: +91 9108220086 • Email: admin@mrsrack.com

